

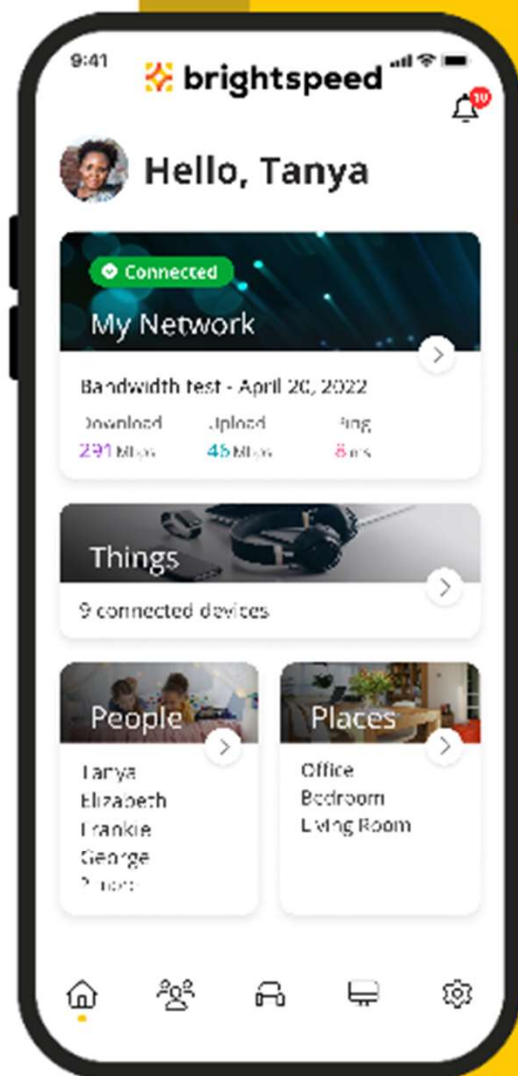

How to set up my Priorities in Enhanced Parental Controls



Enable My Priorities

My Priorities allows you to prioritize bandwidth for certain application traffic or devices

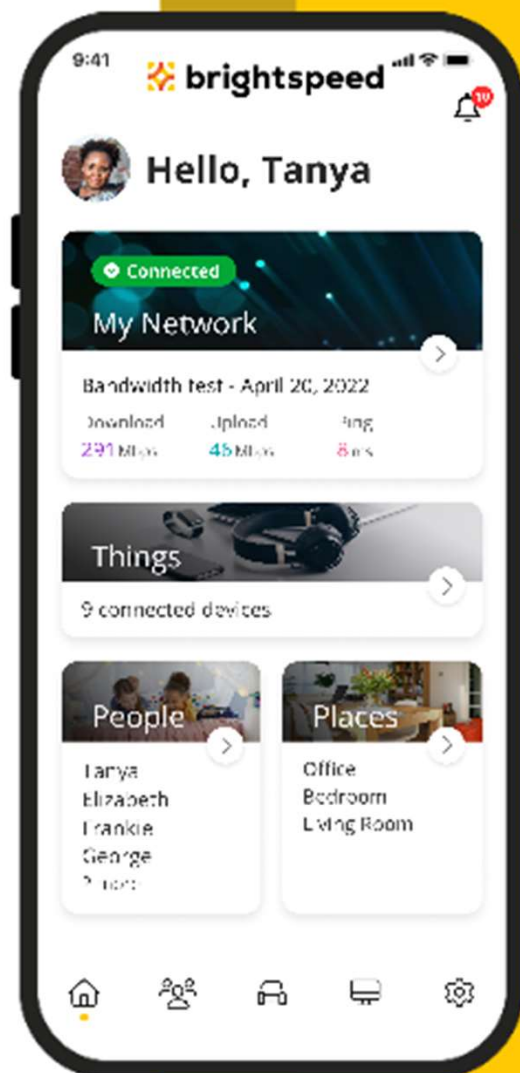

Enable My Priorities

Tap My Network from
the Dashboard

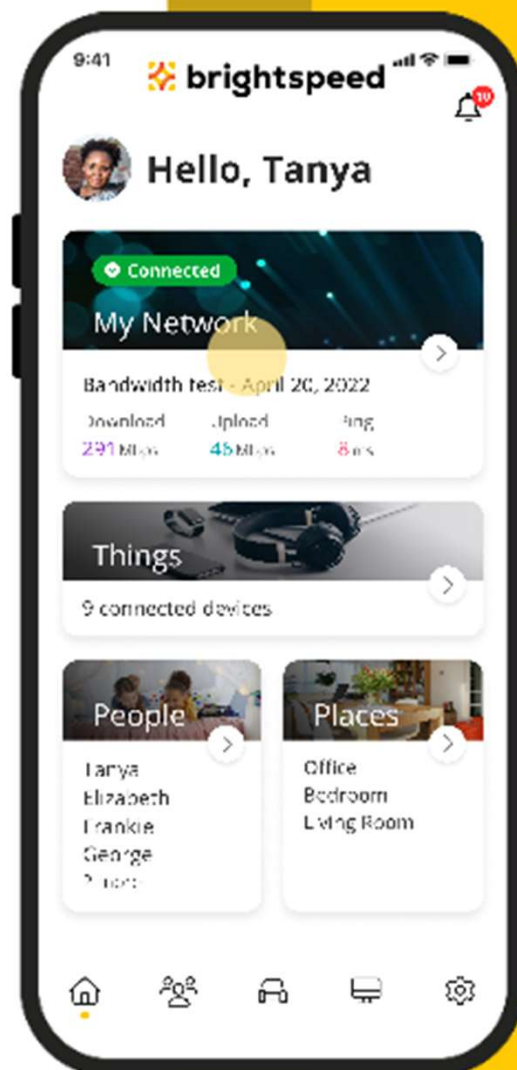

Enable My Priorities

Tap Priorities

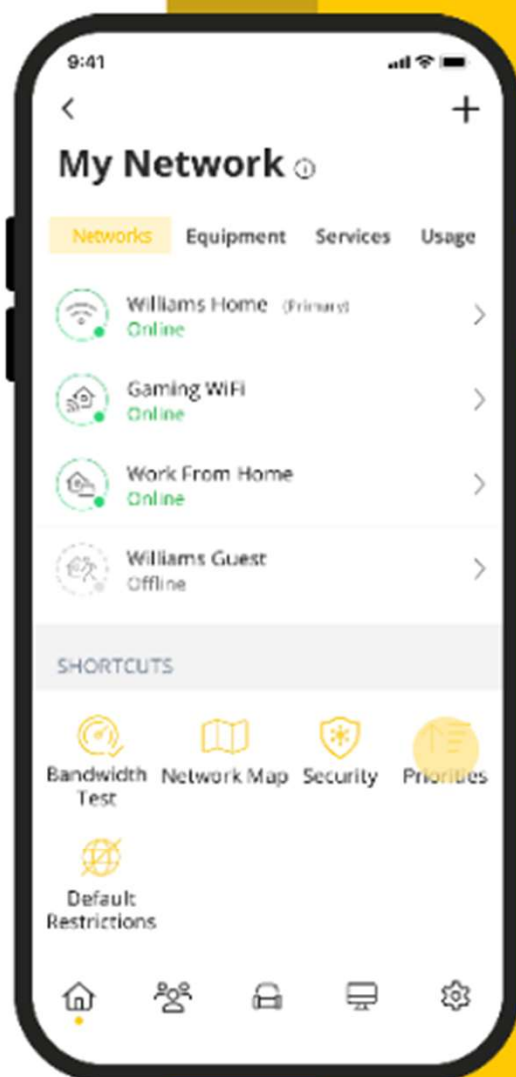

Enable My Priorities
Toggle on to activate

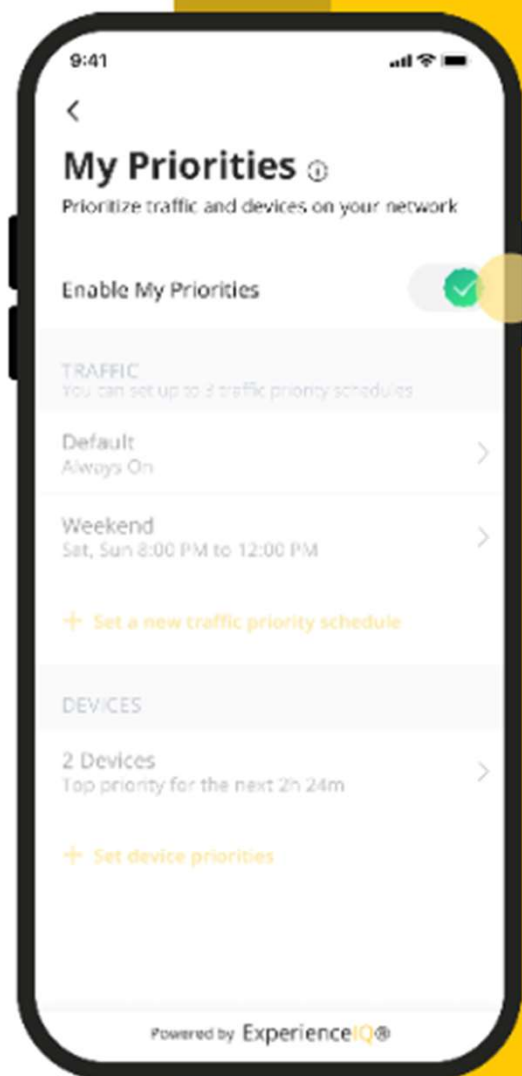

Prioritize by
Application Traffic

Tap Set a new traffic
priority schedule

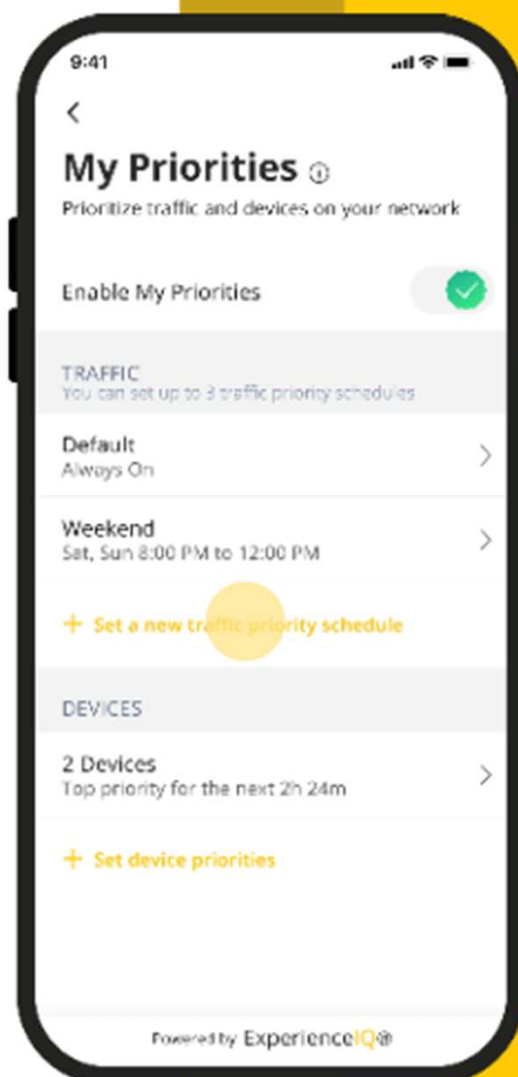

Prioritize by Application Traffic

Enter a name for the
priority schedule

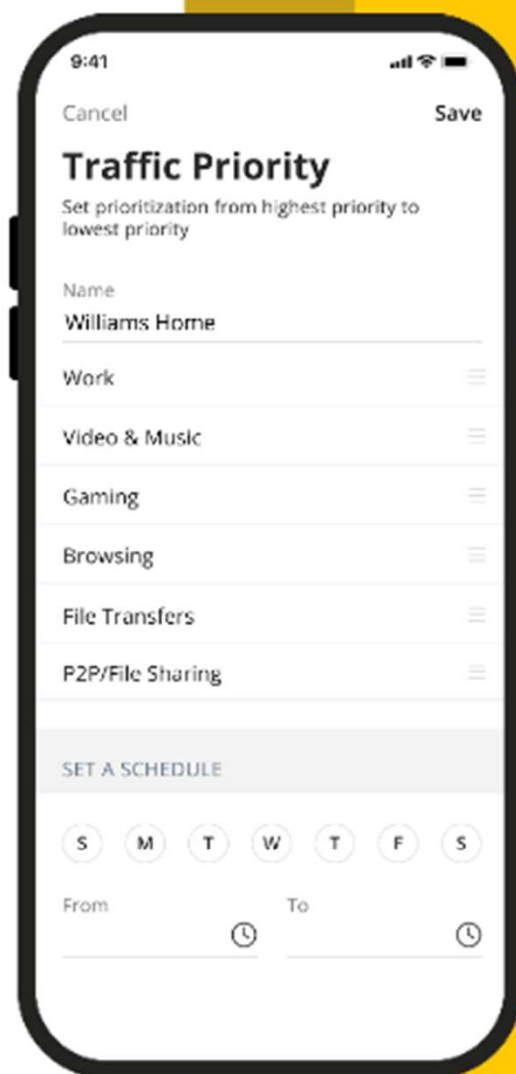

Prioritize by Application Traffic

Arrange the application categories with highest priority first

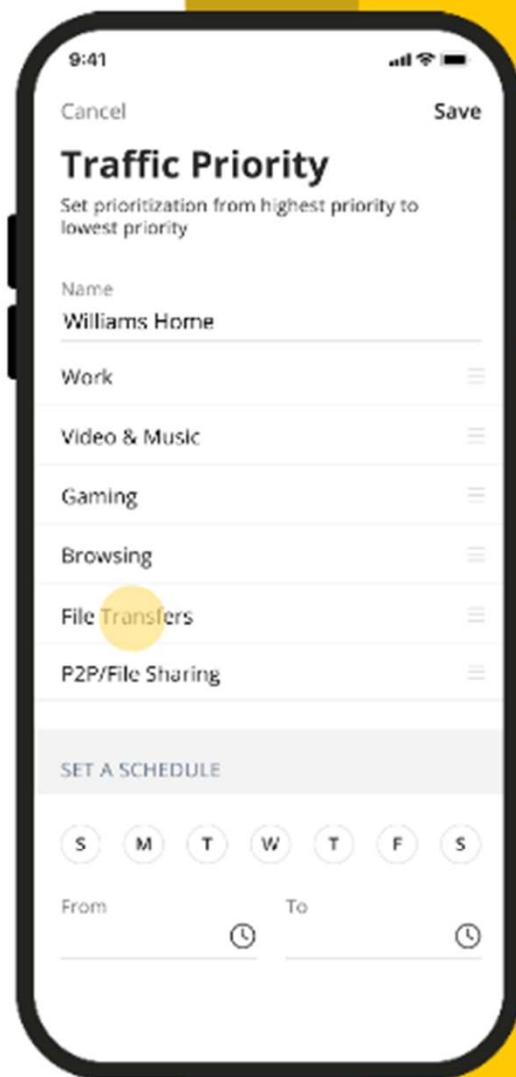

Prioritize by Application Traffic

Arrange the application categories with highest priority first

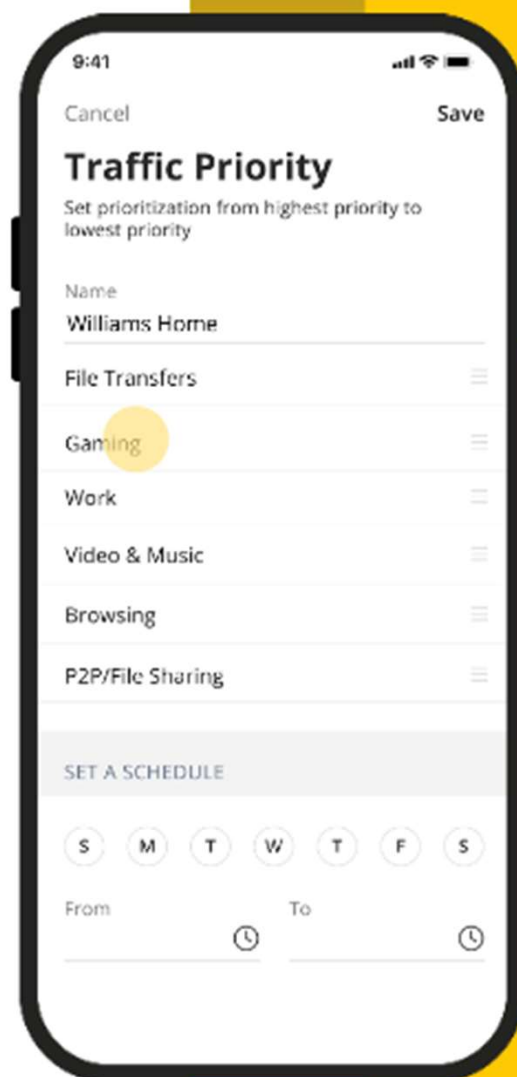

Prioritize by
Application Traffic

Set the days and time
range

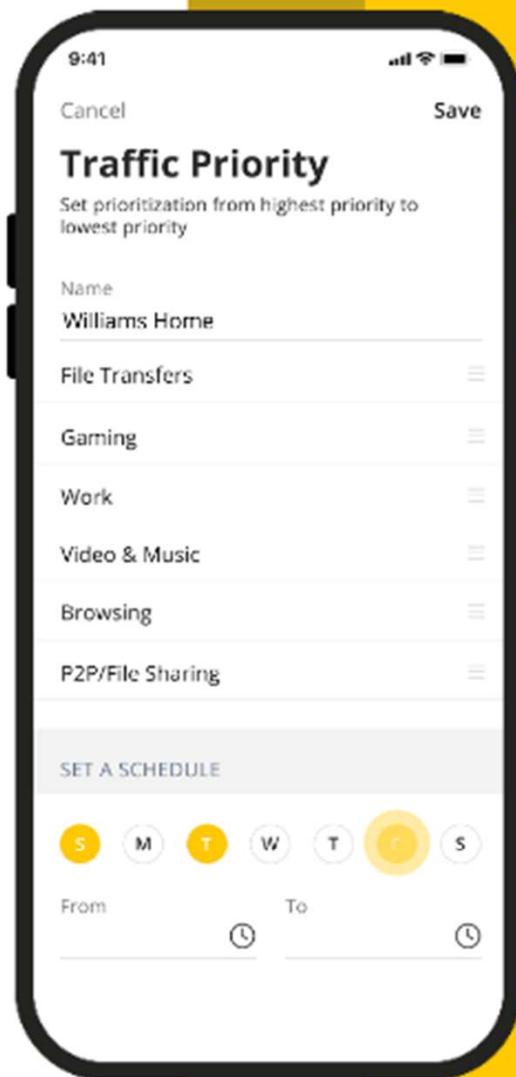

Prioritize by
Application Traffic

Tap Save

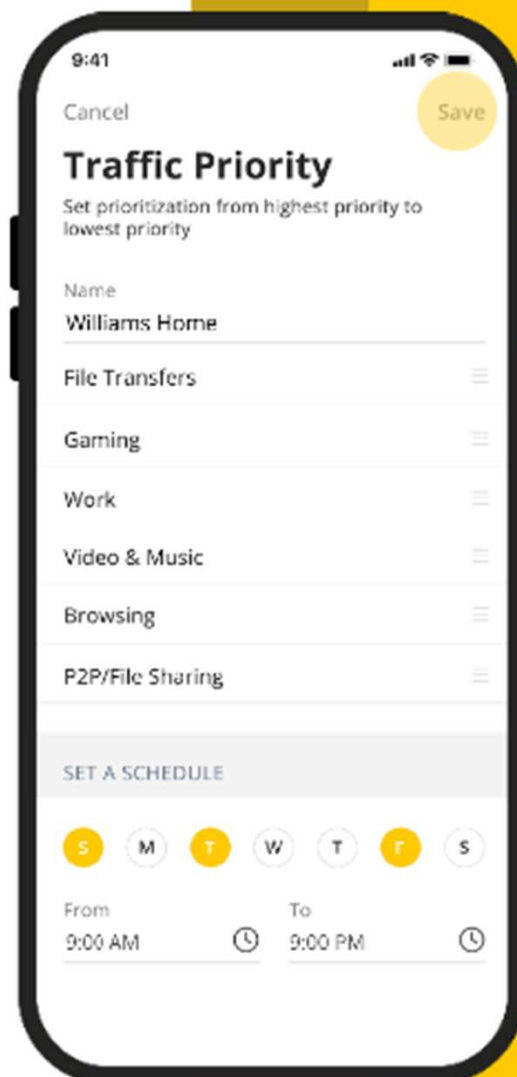

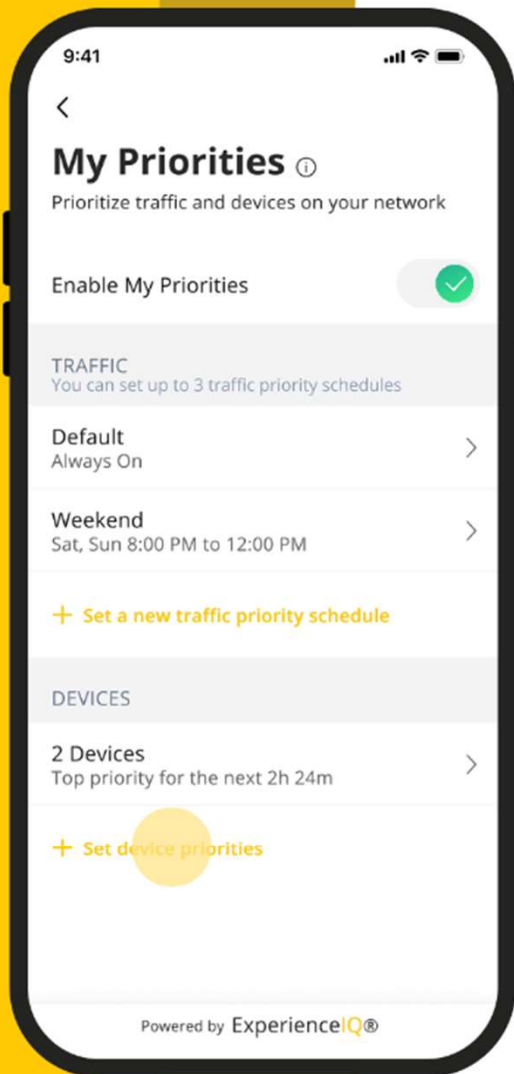

Prioritize by Device
Tap Set device priorities

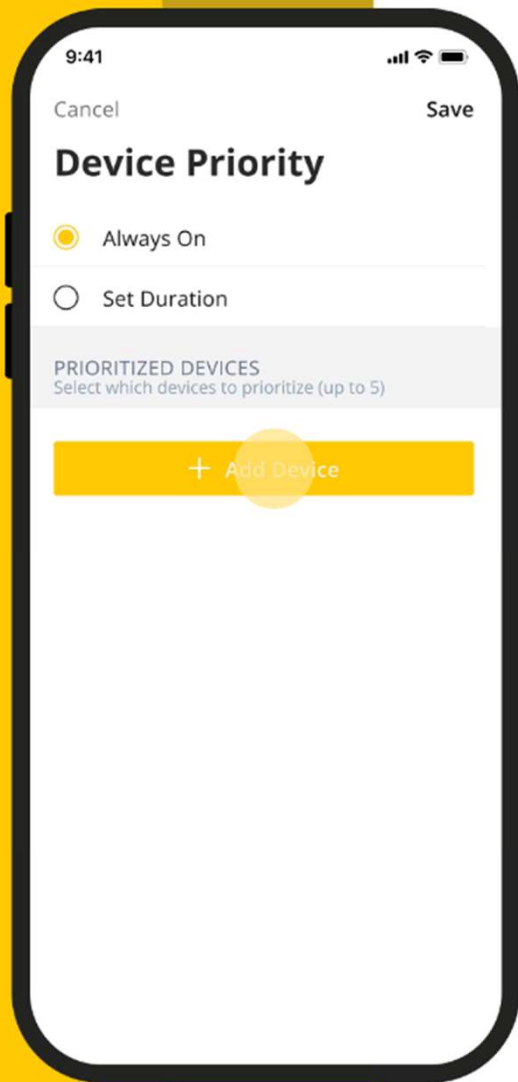

Prioritize by Device

Tap Add Device

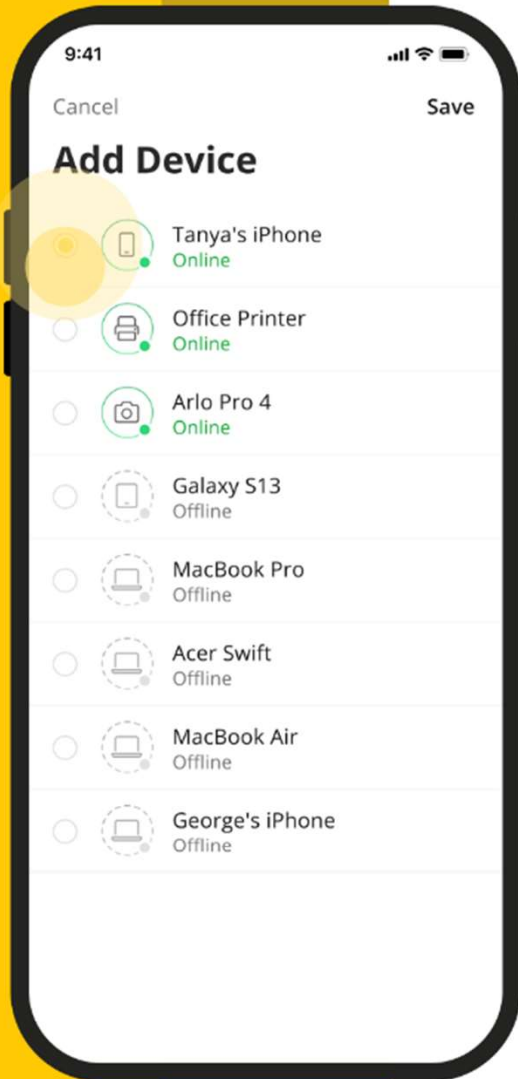

Prioritize by Device

Select up to 5 devices
to prioritize

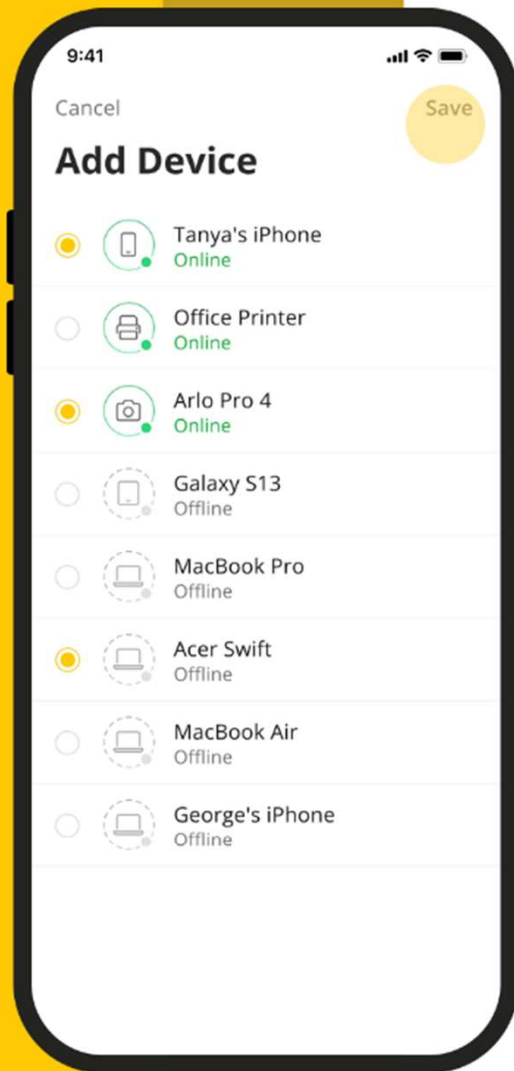

Prioritize by Device
Tap Save

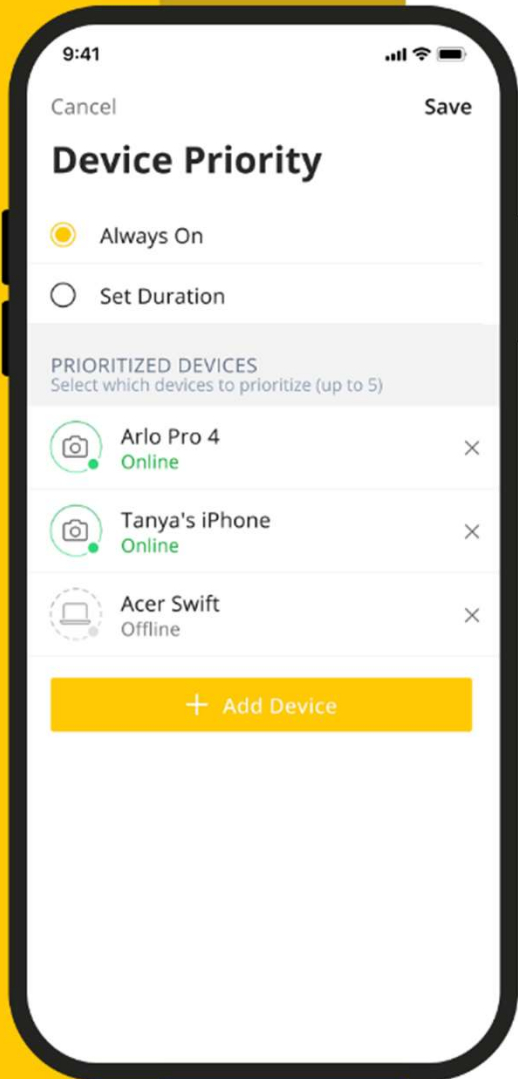

Prioritize by Device

By default these devices
will always be prioritized

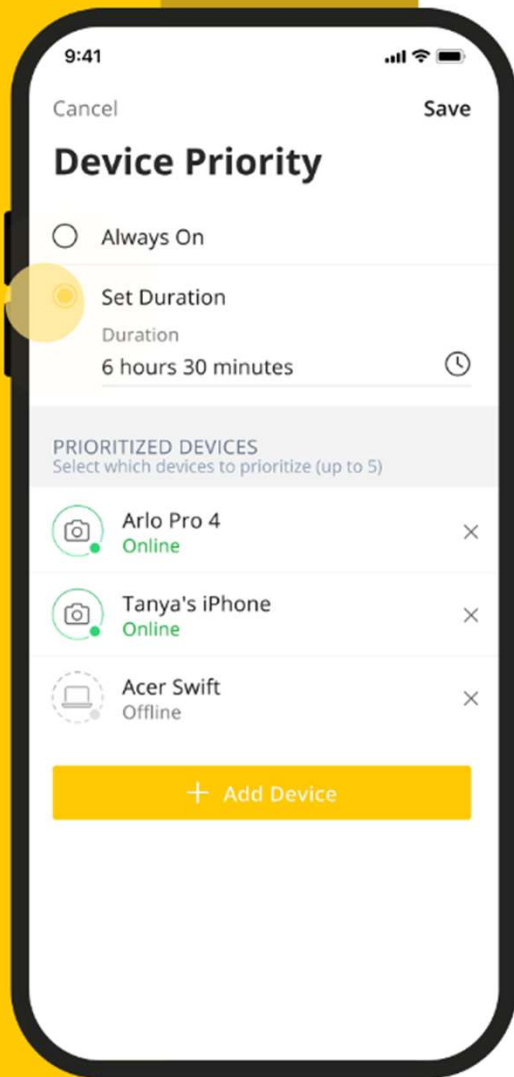

Prioritize by Device

Or you can choose to
prioritize these devices
for a set duration

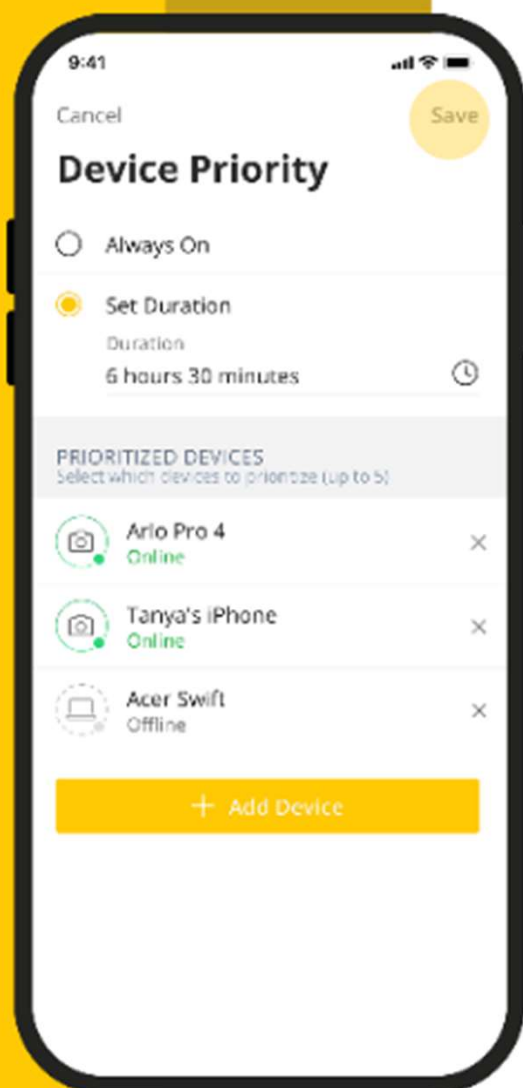

Prioritize by Device
Tap Save



www.brightspeed.com

